

45.000  
[1143]

18.000  
[457.2]

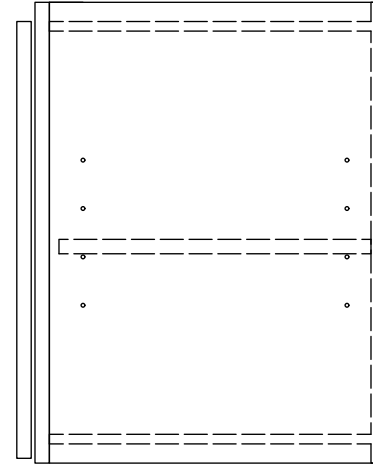
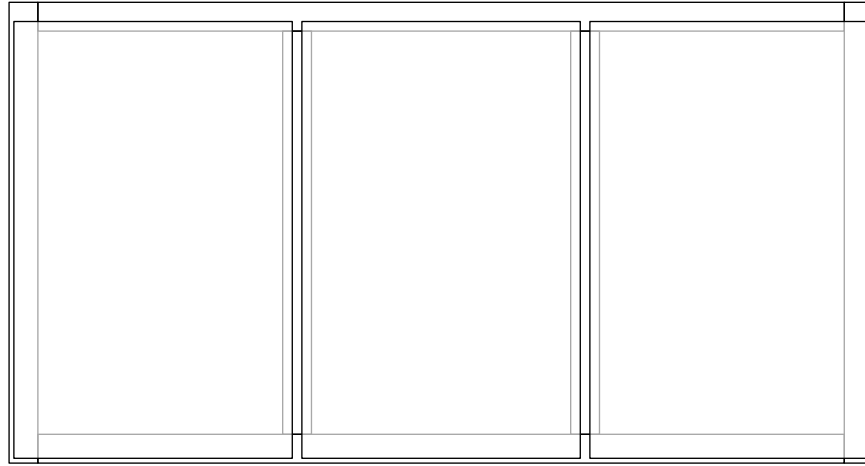

**Notes:**

Custom Parts:

1. Doors: 14.5" X 22.75" (qty 3)
2. Frame: 45" X 24" with 2 interior stiles
3. Top and bottom: 17.188" X 44"
4. Shelf - 16.25" X 43.438"

Customer: VILLFLOOR

Color: White

Door Style: Unknown

Modified Parts -

1. End panels - EP-WXX2424 cut to 18" deep and dado'd

Standard Parts:

1. None

Approval: \_\_\_\_\_

Date: \_\_\_\_\_

| Rev | Description | Who | Date |
|-----|-------------|-----|------|
|     |             |     |      |
|     |             |     |      |

|  |   |   |                    |     |
|--|---|---|--------------------|-----|
| Drawn By: DG                               | TITLE<br>Wall Cabinet 4524 18" deep - 3 Door  |   |                    |     |
| Checked By:                                | TOLERANCES UNLESS OTHERWISE SPECIFIED<br>.000" - ±.031"<br>.001" ±.062"<br>.0mm - .5mm<br>.00mm - 1.6mm<br>Angles ±1° | RiverRun Cabinetry  |                    |     |
| Approved By: DG                            |   | The contents of this material is confidential and the property of of Classic Distribution Inc. (CDI) and must not be used, reproduced, published or disclosed to others without express written consent of CDI. |                    |     |
| Unit of Measure (dual):<br>Inches [metric] | MATERIAL  | DRAWING NUMBER<br>002-80114   | DATE<br>10/08/2024 | REV |
| SCALE 1:10                                 | COLOR/FINISH  |   | SHEET 1 OF 1       |     |