

* This product is intended for use when additional clear open space is required to achieve a 60" ADA minimum turning radius.

306.2.4 Additional Clearance. Space extending greater than 6 inches (150 mm) beyond the available knee clearance at 9 inches (230 mm) above the finish floor or ground shall not be considered toe clearance.

306.2.5 Width. Toe clearance shall be 30 inches (760 mm) wide minimum.

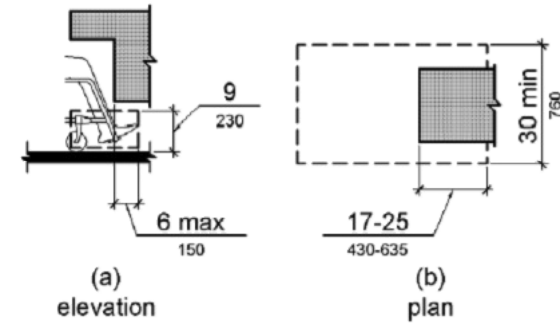
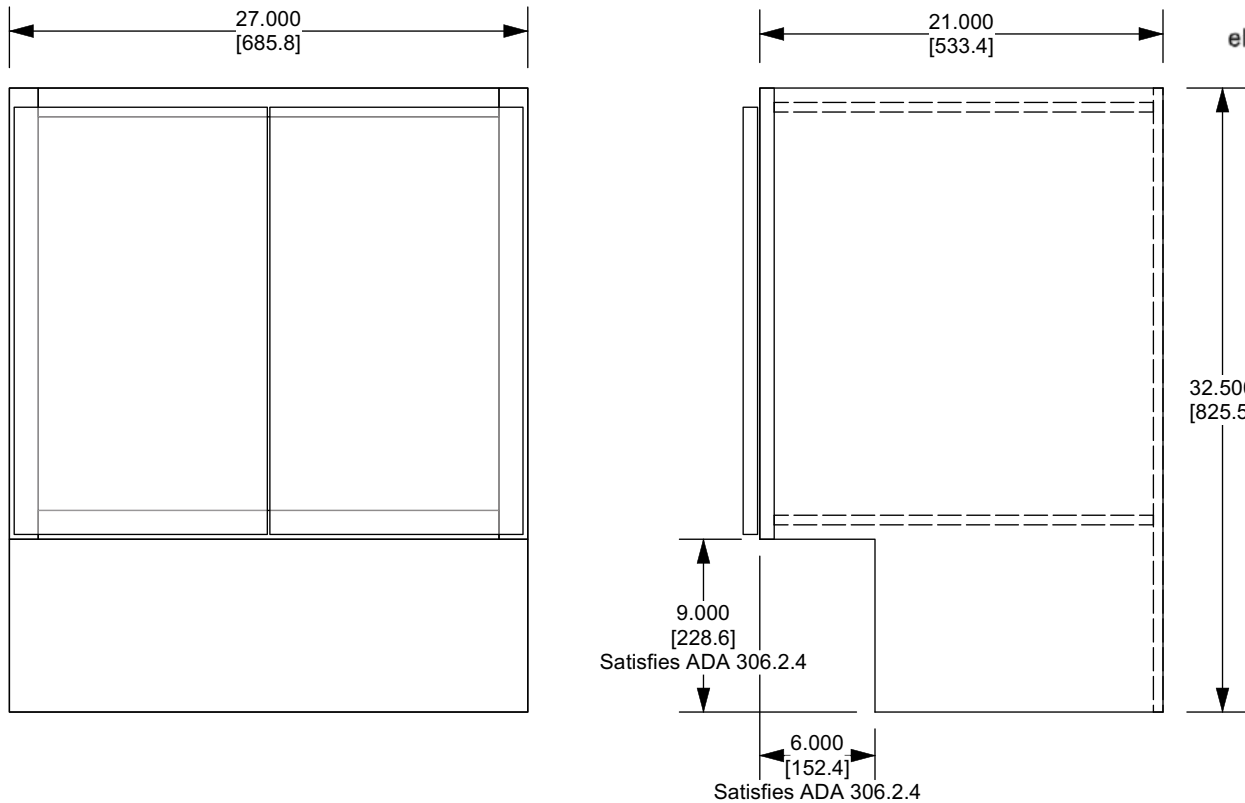

Figure 306.2
Toe Clearance

Custom Components

1. Doors - 13.188" X 22.25"
2. End Panels - 20.5" X 32.5"
3. Back - 26" X 32.5"
4. Frame - 27" X 24"

Modified Components:

1. Floor - FL-B27 cut to 26" X 20.188"

Customer: Virginia Maid Kitchens
Door: Cambridge MDF
Color: White

Approved by: _____

Date: _____

Rev	Description	Who	Date

Drawn By:	NH	TITLE V27 ADA - 9" Toekick			
Checked By:		TOLERANCES UNLESS OTHERWISE SPECIFIED .000" - ±.031" .001" - ±.062" 0mm - 8mm 00mm - 1.6mm Angles ±1°	RiverRun Cabinetry <small>The contents of this material is confidential and the property of of Classic Distribution Inc. (CDI) and must not be used, reproduced, published or disclosed to others without express written consent of CDI.</small>		
Approved By:	NH				
Unit of Measure (dual):	MATERIAL	DRAWING NUMBER	DATE	REV	
Inches [metric]		002-80408	09/16/2024		
	SCALE 1:10	COLOR/FINISH	SHEET	1 OF 1	