

Front Elevation

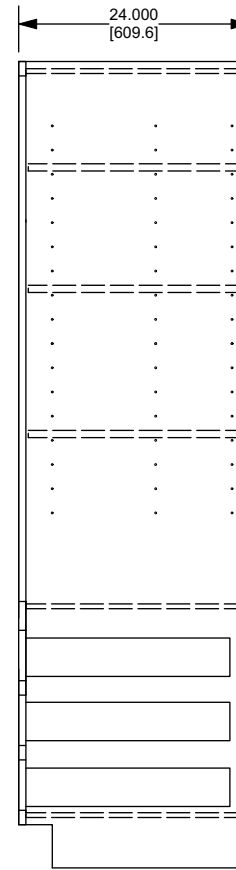

Notes:

Custom Components needed

- 1. Frame - 21" X 79.5"
- 2. End Panels - 23.5" X 84"
- 3. Back - 20" X 84"

Standard components:

- 1. Fronts - None Provided
- 2. Doors - None Provided
- 3. Middle floor - TB-B21
- 4. Top and Bottom - FL-B21
- 5. Shelves - SH-21FD (qty 3)
- 6. Drawerboxes - 4BOXB21-1_EB (qty 3)

Customer: KTUKINGTN
 Door Style: None
 Drawer front: None
 Color: Unknown

Customer Approval: _____
 Date: _____

Rev	Description	Who	Date

Drawn By: DG	TITLE Pantry 2184 - 3 Drawer			
Checked By:	TOLERANCES UNLESS OTHERWISE SPECIFIED .000" ± .031" .00" ± .062" .0mm - .8mm .0mm - 1.5mm Angles ± 1°	RiverRun Cabinetry <small>The contents of this material is confidential and the propriety of of Classic Distribution Inc. (CDI) and must not be used, reproduced, published or disclosed to others without express written consent of CDI.</small>		
Approved By: DG				
Unit of Measure (dual): Inches [metric]	MATERIAL	DRAWING NUMBER 002-80334	DATE 10/16/2024	REV
	SCALE 1:20	COLOR/FINISH	SHEET 1 OF 1	